

MobiLED BF3 Plus

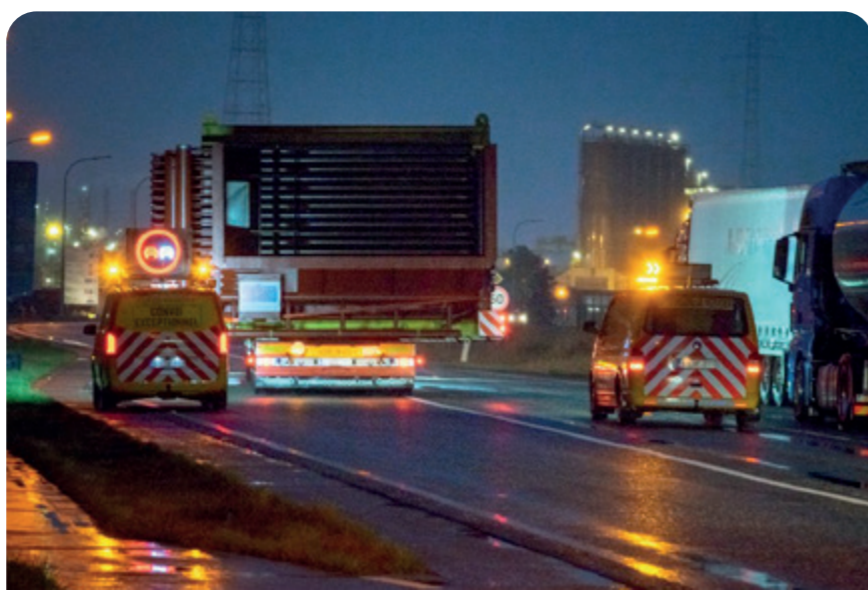
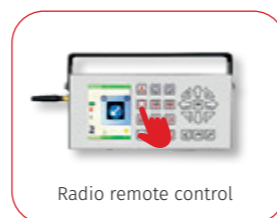

LED Display options

- »» Traffic sign "Attention"
- »» Traffic sign "No Overtaking"
- »» Traffic sign "No Overtaking for Trucks"
- »» Traffic Sign "Driving Ban"
- »» Traffic Sign "40"
- »» Traffic Sign "60"
- »» Traffic Sign "80"
- »» Traffic Sign "100"
- »» Traffic Sign "120"
- »» Traffic Sign "Arrow down left"
- »» Traffic Sign "Arrow down right"
- »» 2 pcs. LED flasher synchro, amber Ø 180 mm

Technical Details

Technical details Heavy Transport Warning System

Design	Roof mount, incl. lifting motor
Wind deflector	Electrical
LED-screen	Single sided
Weight	approx. 115 kg
Voltage	12 V DC
Dimension LED Screen (W x H)	1258 x 1058 mm
Dimension Overall (L x W x H)	approx. 1845 x 1410 x 270 mm
Temperature range	from -20° C to +60° C
Protection Level	IP 54
Night dimming	Automatic
LED colors	3-color technology (red/ white/ blue)
LED Matrix	Fullmatrix
Pixel pitch	20 mm
Warning sheeting	Type RA2, red/ white
Data recording	Blackbox with GPS

Control Unit

Radio remote control with feedback signal and LCD Display

Optional Accessories

Connection Kit
 Side holder for beacons
 Socket base for beacons
 LED beacons

Approvals:

